



Model **PL9547-TUN**
2014-2021 Toyota Tundra
Plug and Play T-Harness

PLUG AND PLAY T-HARNESS INSTRUCTIONS

Package Contents: Plug and Play T-Harness, Instructions

Tools Required: 10mm Wrench

IMPORTANT NOTE: The Plug and Play T-harness Kit works in conjunction when installing the PL8547HD Power Tailgate Lock Kit for '14-'21 Tundra and '16-'21 Tacoma

Step 1: Disconnect the positive cable from the battery to remove power from the truck.

Step 2: Remove passenger side sill plate. Start by gently prying up on the sill plate on the end closer to the rear of the truck. Continue to gently pry, working your way to the other end, closest to the front of the truck.

Step 3: Remove the passenger side kick panel. Start by removing the 10mm plastic nut. Gently pry the kick panel off the bolt and gently pull the kick panel towards the rear and away from the side of the truck at about a 45-degree angle.

Step 4: Locate the MJ1 18 pin connector in the passenger side kick panel. Unplug the male factory connector from the female factory connector. Start by pushing in on clip on the side to release then pull apart. Plug the male end of the Plug and Play T-Harness into the factory female connector. Make sure the clips locks into place. Plug the male factory connector into the female Plug and Play T-Harness. Make sure clips locks into place.

Step 5: Plug the male quick disconnect connectors from long harness of the PL8547HD Power Tailgate Lock into the female quick disconnect connectors of the Plug and Play T-Harness. Matching the blue wire of the long harness to the blue wire of the plug and play harness and matching the green wire of the long harness to the green wire of the plug and play harness.

Step 6: Reconnect positive battery terminal. Test function of the Power Tailgate Lock. Reinstall the kick panel and sill plate.

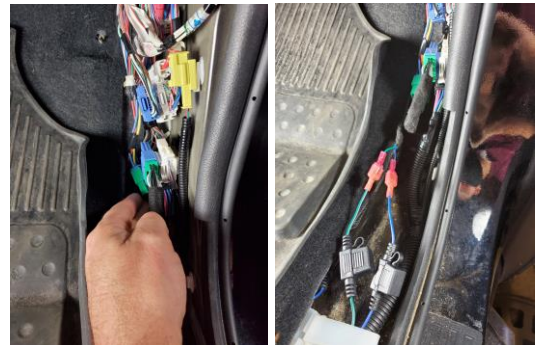
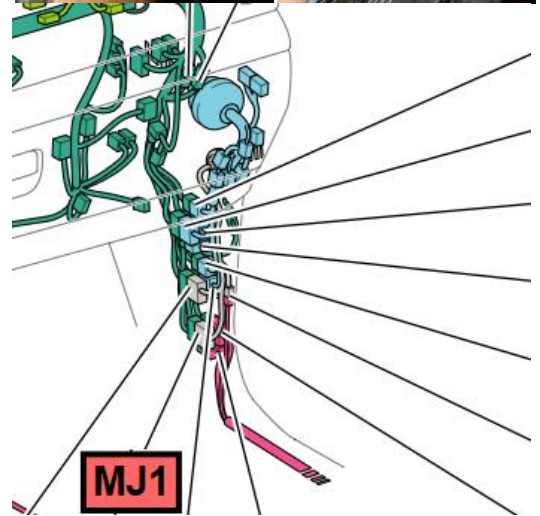

For Tech Support call: 920-283-1933

For the latest instructions please visit www.popandlock.net

LIMITED WARRANTY TERMS AND CONDITIONS

- (1) **Installation.** Pop & Lock™, LLC (and Pop & Lock™ Corporation) is not responsible for installing the Pop & Lock™ or for the harm suffered by any person as a result installing it.
- (2) **Warranties.**
- Customer acknowledges that it is unreasonable to believe that any device whatever will prevent a theft in the case of every attempt and that the most that can be expected from a so-called anti-theft or security device is that it will deter many thieves.
 - **POP & LOCK™ LLC. (and Pop & Lock™ Corporation) MAKES, AND CUSTOMER RECEIVES, NO WARRANTY, EXPRESSED OR IMPLIED, EXCEPT THE WARRANTIES OF TITLE TO THE POP & LOCK™ AND THEIR MERCHANTABILITY, PARTICULARLY NO WARRANTY OF FITNESS FOR A PARTICULAR USE OR PURPOSE OR AGAINST INFRINGEMENT.**
 - As Customer's only remedy, Pop & Lock™, LLC (and Pop & Lock™ Corporation) will repair or replace, at its option and without charge, any lock that is defective in material or workmanship when received by Customer and is returned to Pop & Lock™ LLC (and Pop & Lock™ Corporation), FOB Pop & Lock™ Corporation's offices, within one year after its receipt by the Customer. Pop & Lock LLC will ship all replacement, or repaired, Locks to Customer, FOB Pop & Lock™'s shipping point.
 - Factory support is only available for Pop & Lock™ products purchased as new through an Authorized Pop & Lock™ dealer.
Please Note: Pop & Lock™ Products purchased on auctions sites such as Craigslist etc. will not be covered under factory warranty. Products purchased from an authorized dealer as "new" from an Authorized Seller on websites such as Amazon and Ebay must follow their website warranty policy, process, and procedures. Pop & Lock™ products sold as "used", "refurbished", "open box" etc., cannot be verified by Pop & Lock™, LLC (and Pop & Lock™ Corporation), and as such, Pop & Lock, LLC (and Pop & Lock™ Corporation) is unable to warranty such purchases. Pop & Lock, LLC advises using extreme caution when buying through auction sites as you will be doing so at your own risk.

No Liability. Pop & Lock™ Corporation is not liable for any loss or damage claimed by Customer or any third person to have been suffered or incurred as a result or, or related to, the Locks purchased under this Agreement, regardless of the circumstances or form of action, except any bodily injury or death for which Pop & Lock™ is liable under products-liability law. Without limiting the generality of the foregoing, in no event will Pop & Lock™ LLC be liable to Customer for any indirect, special, or consequential damages, regardless of the circumstances or the cause of action, particularly not for the value of a vehicle, or any other money damages in the event that a tailgate is stolen either notwithstanding the use of a Pop & Lock™ or when it has been returned for repair or replacement.

END OF TERMS AND CONDITIONS

POP & LOCK LLC 1271 CONTRACT DRIVE GREEN BAY, WI USA 54304

Additional Install Instructions and answers to technical questions can be found on our website at www.popandlock.net or by calling

Technical Support 920-283-1933

Monday – Friday 9:00am to 3:00pm CST

Pop and Lock's limited warranty expires one (1) year after date of purchase.

Proof of purchase is required for warranty claims. Please submit a scanned copy or electronic image/photo of your receipt through any of the following methods:

- E-mail: technicalsupport@popandlock.net
- Fax: 920-499-1135
- Mail: 1271 Contract Dr. Green Bay, Wisconsin (USA) 54304

Please be sure to include:

- Name, address and phone number
- Model and year of truck
- Model/Part number of the lock
- Brief description of the problem

